

columns & accessories

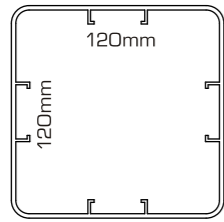

code 890
Supporting column 120X120
combined with cover No262

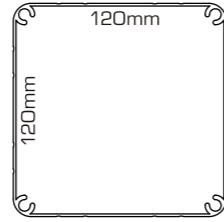

code 901
Supporting column 120X120
combined with cover No262

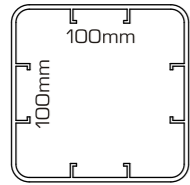

code 889
Supporting column 100X100
combined with cover No261

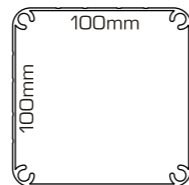

code 900
Supporting column 100X100
combined with cover No261

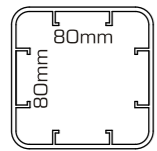

code 882
Supporting column 80X80
combined with cover No260

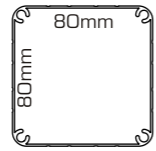

code 914
Supporting column 80X80
combined with cover No260

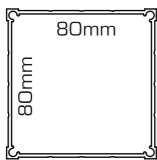

code 25
Supporting column 80X80
combined with cover
No31 & 19 and base No28

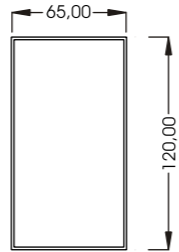

code 59-026
Standard profile

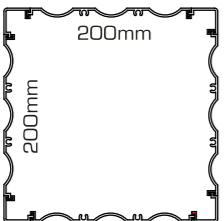

Supporting column
200X200mm.
Consists of 4 pieces
No53 & 4 pieces of No54

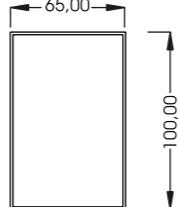

code 59-027
Standard profile

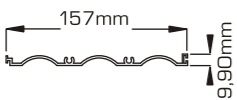

code 53

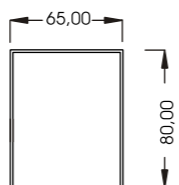

code 59-028
Standard profile

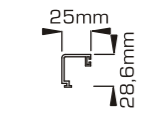

code 54

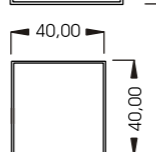

code 29-047
Standard profile

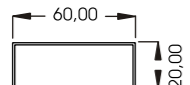

code 59-010
Standard Profile

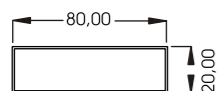

code 59-051
Standard Profile

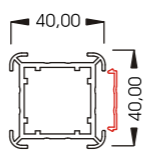

code 923
Supporting column

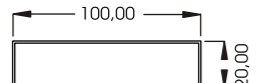

code 59-038
Standard Profile

code 921
Cover column 923

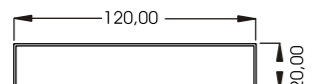

code 59-004
Standard Profile

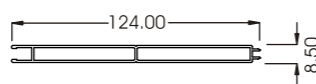

code 99-044
Profile

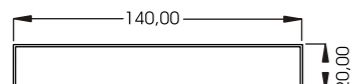

code 59-052
Standard Profile

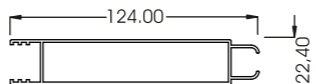

code 99-045
Profile

pergola

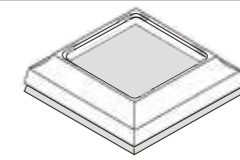
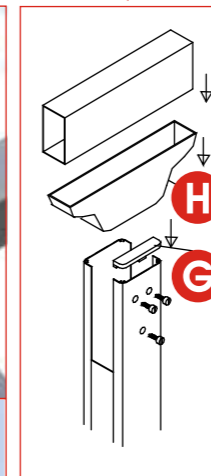
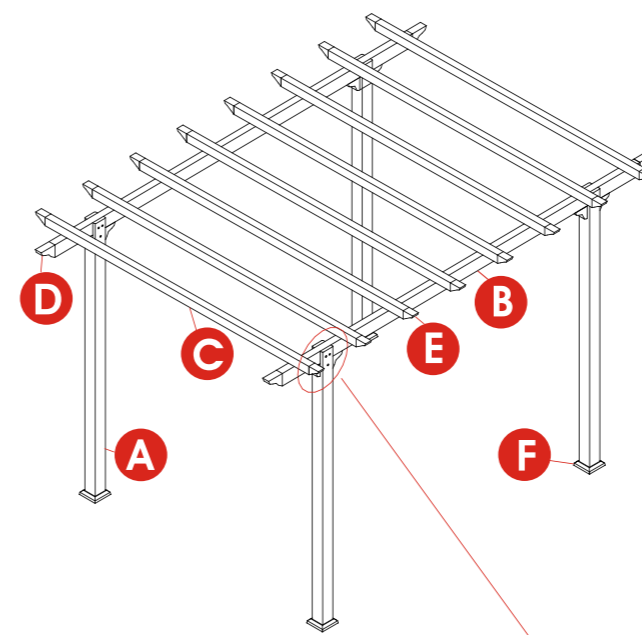

Supporting foot foot column

code 4103 For column 882&914

code 4104 For column 889&900

code 4105 For column 890&901



code 272-221
Cover for column 890 & 901



code 272-220
Cover for column 889 & 900



code 272-219
Cover for column 882 & 914



code 272-200
Supporting base for column

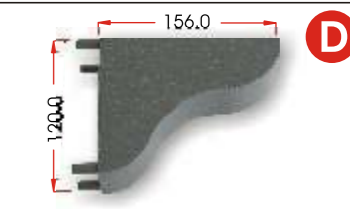

code 272-212
End finishing for column 59-026

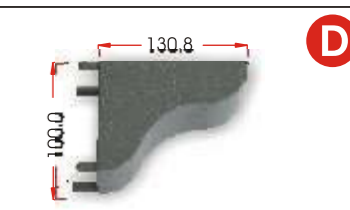

code 272-211
End finishing for column 59-027

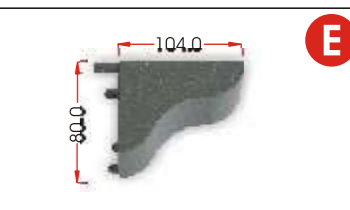

code 272-210
End finishing for column 59-028

